

VEHICULAR ENTRY
AND EXIT VIA BUTE
BUILDING CAR PARK

PARKING

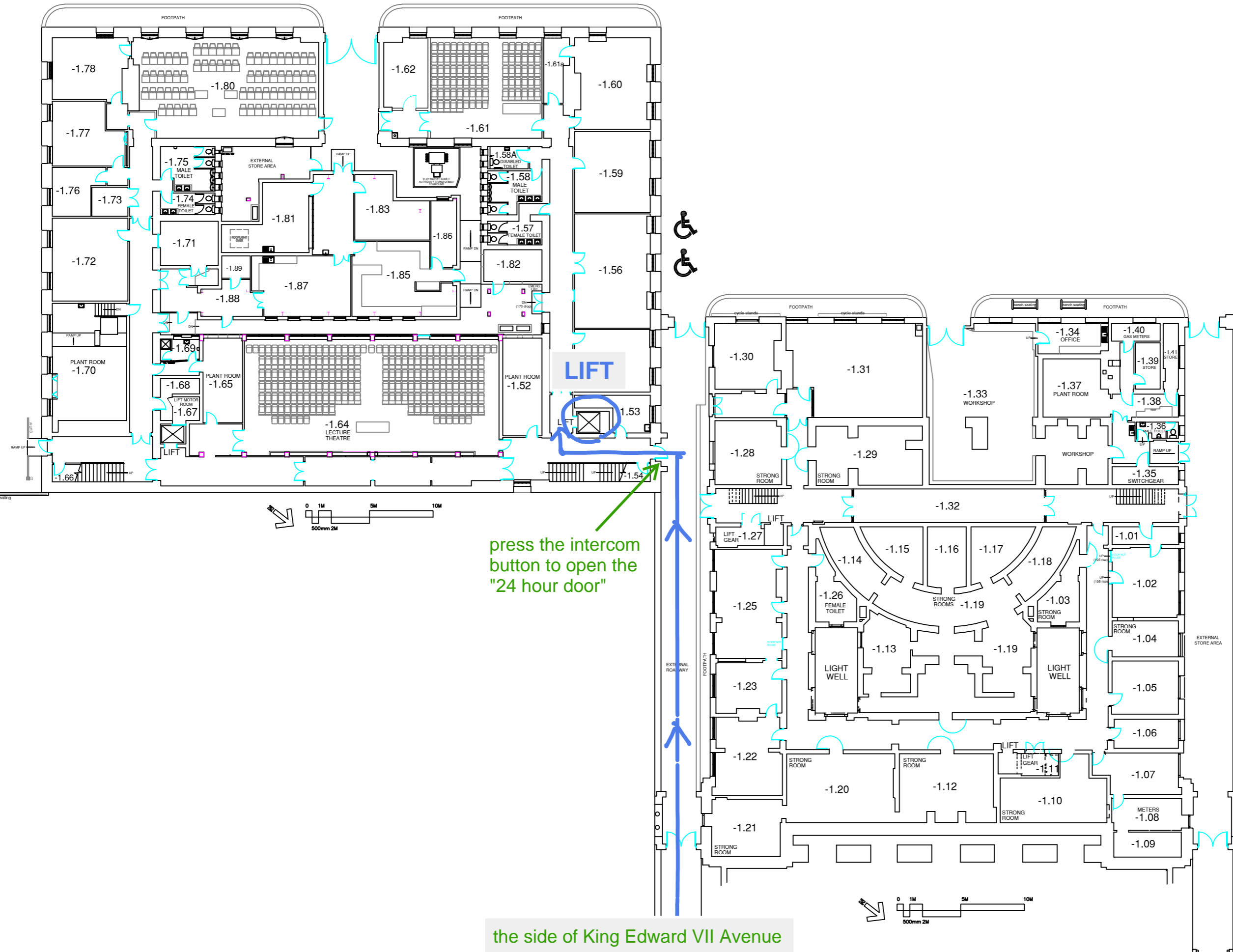

press the intercom
button to open the
"24 hour door"

the side of King Edward VII Avenue



Estates

Title
**GLAMORGAN BUILDING.
LOWER GROUND FLOOR PLAN.**

Scale: 1:300 \A3 SHEET	Original Layout Drawn: GAUNT FRANCIS ASSOCIATES
Last Revised Drawn/Date:	RLF - 29/09/2020
Rec. Drg. No.:	AB \AB02 \FP \-1

Record Drawing